

Part Numbers	Specifications	Applications	Features	Options
<b>6403286</b> PUSHER / PULLER	<b>DIAMETER 10" (255 mm)</b> <b>LOW PROFILE</b> <b>12V 130W</b>	HVAC Systems	Waterproof, IP68 (LL) Long Life Reversible Airflow High Efficiency	Mounting brackets EMC (Certified) Thermal Protector (ELL) Extreme Long Life

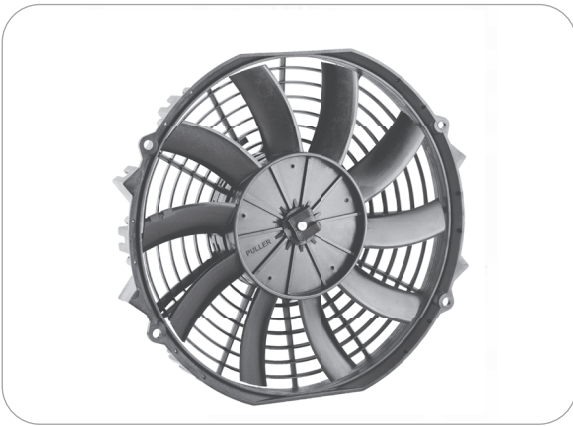

Test Voltage	V	13,0
Nominal Current	A	8,2
Nominal Speed	rpm	2.850
Max. St. Pressure	mmH <sub>2</sub> O	23,0
Max. Airflow	m <sup>3</sup> /h	1.500
Weight	kg	1,5

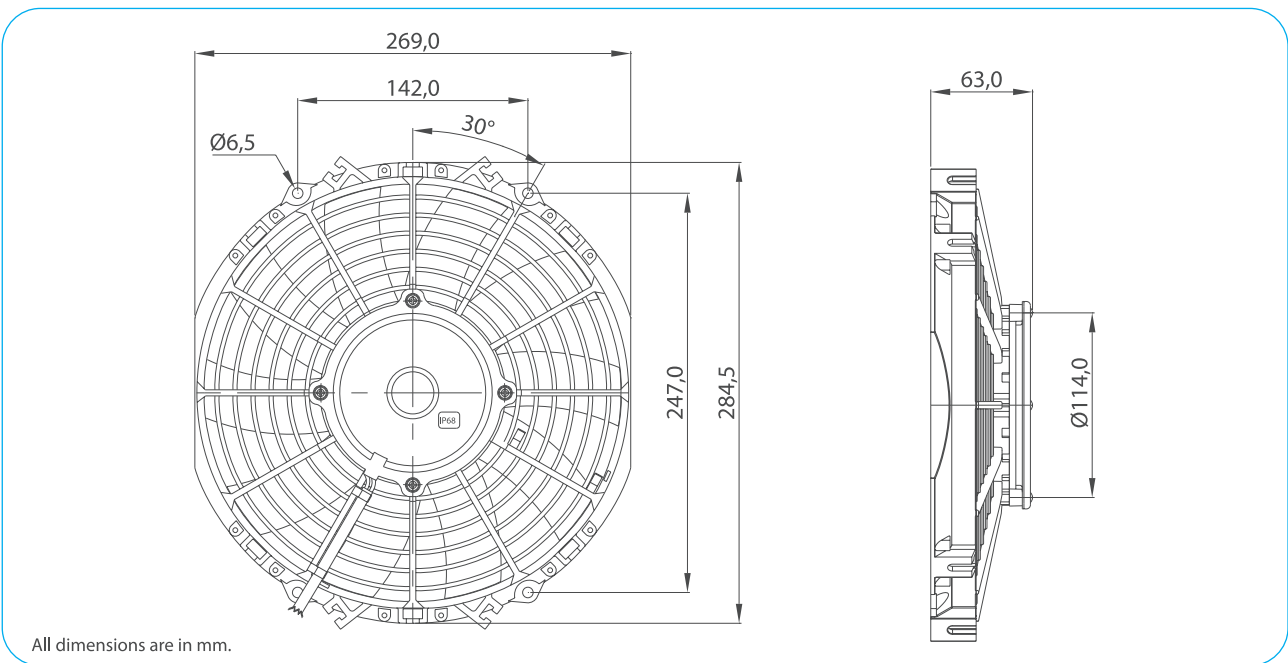

TEST VOLTAGE = 13,0 VDC	Static Pressure	Air Flow Rate	Current
	mm H <sub>2</sub> O	m <sup>3</sup> /h	A
	0,0	1520,3	8,0
	2,5	1399,0	8,5
	5,0	1265,6	8,8
	7,5	1106,5	8,9
	10,0	920,1	8,9
	12,5	702,8	8,7
	15,0	488,8	8,6
	17,5	303,1	8,8
20,0	153,4	9,4	
22,9	0,0	10,3	

Static Pressure: 1 mm H<sub>2</sub>O = 0,04 in H<sub>2</sub>O = 9,8 Pa  
Air Flow Rate: 1 m<sup>3</sup>/h = 0,59 cfm

